

Putting Thought into Lifestyles

Product name	Nickname	Model Number	Release year	Caption	Remarks
Drum-type Washing Machine and Dryer	Lab	NA-V80	2003	A universal design created by the world's first '30°slanting drum'. Greatly reduced energy and water consumption.	
Seated Shower Unit	The Shower	YU-RT44E	2000	Offering a new seated shower experience. Enables older consumers to enter with ease and stability. The first model went on sale in 1996.	
Transfer Assist Bed	Resyone	AP-3030AA001	2014	This care bed joins with wheelchairs to make transfers easier. The first item in the world to be ISO-13482 certified for personal care robot safety.	Panel
Electric Bicycle	Electric Cycle		1980	Japan's first electric bicycle. The originator of the electrically assisted bicycles produced in later years.	

Offering New Routines

Product name	Nickname	Model Number	Release year	Caption	Remarks
First 3-Tube Radio		R-31	1931	The company's first radio won first prize in a radio contest sponsored by the Tokyo Central Broadcasting Station (today's NHK). The product came to be known as Tosengo.	
"Let's note" Notebook PC		AL-N1	1996	The first model in 'Let's note' series dedicated to business use with its high performance along with light and compact portability.	
"Let's note" Notebook PC (with trackball)		CF-S21	1997	Adapted a maintenance free optical track-ball. Its high operability acquired a good reputation.	
"Let's note LIGHT" Notebook PC		CF-R1 Series	2002	At the time, the lightest laptop PC in the world. Realized 10 inch and approximately 960g light weight by adopting the light 1996 rugged magnesium body.	
"Let's note" Notebook PC		W4 Series	2005	At the time, the world's lightest yet rugged laptop PC. Designed to withstand 100kgf pressurized from top side by adopting a shell drive.	
SD Memory Card			2000	Card-type recordable media with a copyright protection function. Standardized as a joint venture with SanDisk (at the time) and Toshiba	
Slim Optical Pickup for Recording DVD		SF-DS29	2008	An optical pickup for CD and DVD recording using a two-wavelength laser to slim down the device. At the time, it was adopted by all seven manufacturers of optical disc drives.	SANYO
Square Quick Connect Ceiling-lock		Electrical Contact Exposed (1963) Electrical Contact Covered (1966)	1963	The original detachable form for modern lighting. When Panasonic developed this, and received JIS certification, it was quickly in use throughout Japan	
High Triangle Tap / High Triplex Tap			1963	Wiring devices that could separate a single outlet into two or three power sources. Our first product when on sale in 1933. This product expanded our subsequent market share, and has continued to be a popular seller down to today.	
Full-Color Wiring Device			1971	Widely in use as safe, reliable, and convenient wiring devices that comply with new regulations. New features, including glow-in-the-dark switches, make your home life richer.	
"Kemuri Toban" and "Netsu Toban" Household Fire Alarms		SH119-S / SH119-H	1979	This battery-powered household fire prevention device combines detectors and warning buzzers in one un	
Wireless Video Intercom		VL-SW102K	2004	Our first model of the world's first video intercom with a wireless monitor unit in the "Dokodemo Intercom" Series. Users could respond with voice or video from anywhere inside their house	
Guide Light		FA11923	1964	Panasonic's first guide lighting. As the laws that govern firefighting are under revision, Panasonic has taken the lead to successfully develop new technologies and incorporate them into new products.	
"Otakkusu" Personal Facsimile		KX-PW1	1991	Panasonic's first personal fax machine. The product was a huge hit and just three months after its release it held the top market share in its class.	
"GOPAN" Rice Bread Cooker		SPM-RB1000	2010	The world's first rice bread cooker which enabled the user to easily bake bread using rice. The product received universal acclaim as one which helped to improve the food self-sufficiency ratio in Japan.	SANYO
"ROBO Series" Home Appliances for Children			1988	A series of products developed for young children. With a desire to provide children with genuine products, these toys were equipped with the latest technology.	SANYO
Massage Sofa		EP-MS40	2009	Compact, and designed to blend into any interior, this massage chair also serves as furniture for your home	
"PANACORAN" High Frequency Therapeutic Device		EW554P	1997	This treatment for stiff necks and shoulders was previously only available at the doctor's office. The first model, the EW555, went on sale in 1989.	
Air Humidifier/Purifier		F-VXG80	2012	Quickly controls annoying air quality issues with nanoe and assist-ion effects.	
Jet Bath	Milky Bath		1989	A microscopic foam spreads across the tub to create a jetted bath with the feel of a milky white hot springs bath. With less load on the body, you can be more thoroughly warmed as you relax.	Panel
"Matsukaze"Q Blade Electric Stand Fan		F-30H1F	1975	A hit series for the company's fans. Utilized "Q blades" which smoothed the flow of wind.	
"1/f Fluctuation of Wind" Velocity Electric Fan		F-C303E	1988	This fan sends a natural breeze, which Panasonic calls a 1/f Rocking Breeze, that envelops you in a comfortable, natural rhythm. After measuring and analyzing breezes on mountain plateaus, they were reproduced with a DC moto	
Dressing Table	Associe		1984	With a larger sink, and an attached shower head, this vanity accelerated the morning shower fad in Japan.	Panel
Dressing Table	Twin Line LED Lighting		2013	With two rows of lighting along the sides, the face could be brightly illuminated. We created a new type of vanity lighting that could shine on consumers, regardless of their height.	Panel
Electric Razor		MS10	1955	The first electric razor in Japan. Made possible with Panasonic's proprietary electromagnetic vibration drive.	
"Philshave" Electric Razor		ES-70	1960	The first rotating blade electric razor in Japan. Our first model from our collaboration with Phillips.	
"Super Razor" Electric Shaver		ES862	1983	The next Super Razor series product, continuing on from 1981. Sales of this product in 1983 heralded the start of Panasonic's global functionality campaign.	
"TWIN EX" Electric Shaver		ES4025	2002	Panasonic's first ergonomically curved model, based on human engineering ergodynamics	
"LAMDASH" Electric Shaver		ES8092	2002	The first model in the Lamdash series. Established a new standard for shavers with three pioneering innovations, including the first blade angle of 30 degrees	
"soie" Hair Remover		ES260 / ES261	1992	The first soyle in-home depililator. Using Panasonic's proprietary swing-disc method, it made for easier hair emoval as the head swivels to match pore directions.	
"esthé jeune" Beauty Equipmen		EH240W	1990	The first model in the Esthe Jeune series. Easily enabled a full course of facial treatments at home	
"esthé jeune Ion Steamer nanocare" Beauty Equipment		EH2425	2004	Generates nano-particle ion steam, with a volume that is roughly 1/8000 in size compared to normal steam. Popular as a household steamer.	
"ionity nanocare Windpress" Hair Dryer		EH5421	2005	The first dryer with faintly acidic nanoe features. Proposing a new concept, for hair dryers that offer hair treatments.	
Hair Dryer		EH-NA90	2008	This hair dryer offers better wave control with on-board, new, nanoe features.	

*Exhibits are subject to change.

Panasonic

Panasonic Museum Hall of Manufacturing Ingenuity Products List

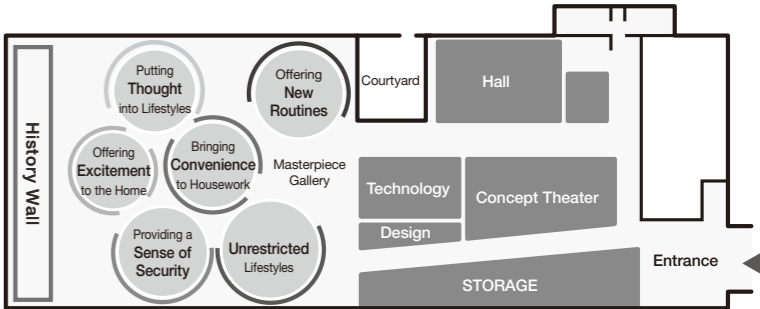

Entrance

Product name	Nickname	Model Number	Release year	Caption	Remarks
Improved Attachment Plug			1918	The company's first product	Replica
Double Cluster Socket			1918	Commonly called 'Two-way Socket'	Replica
National Lamp			1927	The first National brand product	Replica
First 3-Tube Radio	Tousen-gou	R-31	1931	The company's first in-house radio	
Electric fan with automatic oscillation			1936	The company's first electric fan	
Round Stirring-type Electric Washing Machine		MW-101	1951	The company's first electric washing machine	
Black and White Television		17K-531	1952	The first National brand television	Replica
Electric Blender		MX-2	1952	The company's first motor-driven kitchen appliance produced	Replica
Electric Refrigerator		NR-351	1953	The company's first refrigerator	Replica
Cool Air Conditioner		W-31	1958	The company's first cool air conditioner	Replica
Automatic Electric Rice Cooker		SR-18	1959	Start of growth in rice cooker business	Replica
Microwave Oven	Panacook 7	NE-700	1966	The company's first microwave oven	

Masuda Collection

Design

Product name	Nickname	Model Number	Release year	Caption	Remarks
Personal Electric Fan		20B1	1952	The first electric fan designed by Yoshikazu Mano after joining Matsushita Electric.	
Radio	5-Tube Gem Super Heterodyne	DX-350	1953	this radio received a special prize at the 2nd Mainichi Industrial Design Competition.	
Hi-Fi Stereo Radiophonograph	Asuka	SE-200	1963	Modeled after an ancient Japanese architectural style, the form emphasized straight lines. Designed to position a stereo amongst luxury furniture.	
Cylinder Electric Vacuum Cleaner		MC-1000C	1965	With graceful curves made possible with molded plastics, this item heralded the dawn of the age in which plastics took center stage.	
Concise Component		Technics	1978	This design combined precision and luxury in a compact form, utilizing die cast aluminum.	
Electric Shaver	Super Razor	ES820	1977	The t-shaped design called to mind safety razors. The easily held grip made its way to future Panasonic shavers.	
Radio	Toot A Loop	R-72	1970	Designed to be a fashionable objet, it's playfulness captured the hearts of younger people.	
Radio	Cougar	RF-888	1973	Characteristic for its large frontal speakers, the sturdy design enabled more fun outdoors.	
Television Monitor	αTube	TH-28DM03	1985	This design emphasized the CRT component of the television. The concept highlights floor life, where televisions could be placed on the floor.	
Record Player		Technics SL-10	1980	This ultra-modern design encapsulated delicate techniques in the size of a record jacket.	
Television	Piedra8	TH-8U1	1988	The asymmetrical form is akin to natural stone formations. The portable design made you want to touch it.	
Powerful Light	Mighty Flexible	FF-102	1985	The bendable neck, that enabled lighting at any angle, was unique. This design played on the fun inherent in tools.	
CD Radio Cassette	Cobra Top	RX-DT75	1993	With all controls together in the pop-up top, this design realized powerful audio with its rounded form.	
Coffee Maker	SEG Series	NC-A01	1991	This design made the experience of drinking coffee a richer one, with its mirrored stainless finish offering a genuine feel.	
Tabletop Light	Hanasabi	SF260K / SS276	1994	This design pursued Japanese hospitality together with a relaxing space, reflecting the aesthetics of Japanese tea ceremonies.	
Hair Dryer	nanocare	EH5441	2006	This design became the model for Panasonic dryers, naturally expressing the gentle flow of wind.	
Juicer / Blender		MJ-W90	2000	The two-tone 'vitamin' color design expressed exquisite taste, and reminded the user daily to maintain a healthy lifestyle.	
LED Multiple Battery Light		BF-104	2005	This design emphasized the thickness and shape of batteries, making it clear that any batteries could be used.	

Bringing Convenience to Housework

Product name	Nickname	Model Number	Release year	Caption	Remarks
Super Electric Iron			1927	The first electric iron produced by the company. The cost of manufacturing was more than 30% less than conventional models, and as a result, the product was recognized with an award for excellence in domestic-made products.	
Pulsator-type Washing Machine		MW-303	1954	The company's first washing machine with a built-in clothes wringer. The machine combined a hand-cranked clothes wringer with a jet-stream washer.	Replica
Automatic Electric Rice Cooker		SR-15	1959	Japan's first ever electrical product to be accredited with the LA mark from the City of Los Angeles Building and Safety Electrical Test Laboratory.	
Electric Automatic Dishwasher		MR-500	1960	Our first bread maker. The entire bread making process is carried out automatically after the correct program is selected and the machine is switched on.	
Microwave Oven	Elec & Oven	NE-8500	1978	A multi-purpose microwave oven with microwave, convection oven and grill functions. The grill-marking heater made grilling possible.	
IH Electronic Rice Cooker / Warmer		SR-IH18	1988	Japan's first induction heating (IH) rice cooker.	
Automatic Home Bakery		SD-BT2	1987	Our first bread maker. The entire bread making process is carried out automatically after the correct program is selected and the machine is switched on.	
Built-in Induction Heating (IH) Cooking Equipment All Metal Heating Type		KZ-321MS	2002	The first ever domestic IH cooker with the capability to heat all types of metal. It could be used with multilayer pans, copper pots and aluminum pots.	
2-door Freezer/ Refrigerator	Chotto Ookime Hanataba	NR-256AF	1977	Our most popular fridge-freezer. The freezer was made larger as bulk buying of food became more widespread.	
Photocatalyst-coated Exterior Material	Hikarisera		2002	The power of photocatalysis dissolves dirt, rinsing it from walls. The non-mechanical ceramic coating also prevents against ultraviolet fading.	KMEW
Wooden Flooring	O Mighty Flooring		2001	Flooring with a superior finish and no need for waxing. A proprietary Panasonic product with a fluoride coating layer and a special MDF base material that is more resistant to scratches and dents.	
Self-cleaning Toilet	A La Uno		2006	The world's first auto-cleaning toilet made from a resin using new materials related to organic glass, which used bubblesto remove dirt. Improved water saving with the use of a turn trap.	
Modular Kitchen	O'made		1997	This customizable kitchen series is available to fit any lifestyle. Implemented with a dedicated planning team.	Panel

*Exhibits are subject to change.

— 1 —

Panasonic Museum



Masuda Collection

Bringing Convenience to Housework

Product name	Nickname	Model Number	Release year	Caption	Remarks
Storage System	Soft Down Wall Unit		1998	The first storage mechanism in Japan that can bring items from higher shelves down to hand level. Effectively utilizes space, and easy for shorter persons to use as well.	Panel
IH Stove	Triple Wide		2009	A stove platform with a new arrangement of three burners. Enables easier sequential cooking, and well as cooking for multiple persons in the same household.	Panel
Artificial Marble Bathtub	Acryge		1986	An artificial marble tub with a superior finish that is more resistant to scratches, shocks, and discoloration. With a feel similar to natural stone, this long-selling hit product is still on the market today.	Panel
Room Air Conditioner with Filter Cleaning Robot		CS-E255A	2005	The world's first ever room air-conditioner fitted with a 'filter cleaner robot' with auto suction and emission technology.	
Electric Clothes Dryer		MK-800	1959	Japan's first electric clothes dryer. Made washing and drying possible even in rainy weather.	
Dewatering Washing Machine	Uzushio Automatic	N-3000	1966	The top model twin-tub washing machine. It was extremely popular due to its large spin-dryer and washing tub and its range of programs which enabled the user to select a different water flow speed for each type of fabric.	
Fully Automatic Washing Machine	Aisaigo	NA-F60H1	1995	Japan's first washing machine which simulated hand washing, and enabled users to wash garments labeled as 'dry cleaning only'.	
Cordless Steam Iron	SePaRe	NI-S2000L	1988	Japan's first cordless steam iron. Ironing is made much easier as the iron doesn't have an electric cable ttached to it.	
Paper Bag Vacuum Cleaner	Canister	MC-250C	1982	Our hit vacuum cleaner. It established its place as Japan's mainstream vacuum cleaner thanks to its convenient paper dust bags and its shape which enabled it to stand up vertically on stairs.	
Cassette-type Dust Collecting Vacuum Cleaner	Taro	SC-3000	1968	The world's first vacuum cleaner using a cassette. The dust collected was compressed to keep hands clean when disposing.	SANYO

Offering Excitement to the Home

Product name	Nickname	Model Number	Release year	Caption	Remarks
Television		T-14C1	1958	Not only did this product realize the popular price of around the ¥60,000 mark, its performance and cutting-edge design ensured it was a huge hit.	
Color Television	Quintrix	TH18-E25 (N)	1974	A super-hit color television. We achieved high picture quality, a low energy consuming and resource-saving design, and a low price, through the use of a five-electrode, three-lens cathode ray tube screen.	
Large-screen Television with BS Tuner	Gaoo	TH-33VS10	1990	Hit series of televisions developed to handle multi-channel satellite broadcasting. Special features were a built-in BS tuner and a large cathode ray tube screen.	
Digital High-vision Plasma Television	VIERA	TH-42PX20	2003	The first model in the VIERA series. Integrated terrestrial/BS/110°CS digital tuner for high picture quality.	
1/2 inch Video Tape Recorder for Home Use		NV-1010	1966	Our first ever home-use video. The half-inch format made the device very small.	
Video Tape Recorde	Videomaster	NV-201	1964	Our first ever video. This 1-inch VTR, small for its time, achieved a price point of ¥2,500,000 – one tenth of the price of a broadcast video.	
4-hour VHS Video Cassette Recorder for RCA		VBT-200	1977	The first ever four-hour recording capability. Developed to enable users to record an entire American football match, a sport which was very popular at the time in North America.	
All Transistor Tape Recorder	Mysonic	RQ-303	1963	The first three-in-one head in the world. Developed to popularize the tape recorder, it was launched to market at ¥10,000 – half the price of conventional products.	
Hi-Fi Stereo Radiophonograph	Utage	SE-6500	1965	The top model stereo cabinet incorporating elements of traditional Japanese aesthetics.	
Car Stereo		CX-801	1967	The company's first car stereo. Jointly developed with Victor Company of Japan, it went on sale at the same time as music tapes. The product saw huge demand as 'the stereo that runs'.	
Electronic Organ		SX-601	1963	Panasonic's first electronic organ. As well as reproducing the sound of mandolins, flute and numerous other instruments, combining those sounds meant users could play the same music as a whole band on just one device.	
High-performance Small Speaker System	Technics1		1965	Technics1 The first Technics model. A compact device which produced standard floor speaker system level bass sound.	
Direct-Drive Turntable		Technics SP-10	1970	The world's first direct drive turntable. Its performance, which eliminated vibrations and uneven rotation, was well received throughout the world.	
Direct-Drive Turntable		Technics SL-1200	1972	The benchmark devise in the direct drive record player series which brought about the DJ culture. It was produced for nearly 40 years, during which it was famous for its stable rotation.	
Stereo Control Amp		Technics SU-10000	1972	Technics SU-10000 The Technics 10000 series models were developed as the highest-performing preamplifiers at the time.	
Speaker System	Technics 007	SB-7000 Mini	1976	In order to faithfully reproduce music waveforms, the Technics 7 SB-7000 1/2 model speaker system adopted Technics' unique linear-phase design.	
2-band (AM/FM) Cassette Tape Recorder with Radio		RQ-231	1967	Japan's first ever radio cassette player, which enabled the playing and recording of radio broadcasts in one device.	
VHS Video Cassette Recorder	MacLord	NV-8800	1977	Our first ever VHS video. It was designed as a home VTR able to provide two hours of recording.	Replica
Hi-Fi VHS Video Cassette Recorder	Hi-Fi MacLord	NV-F15	1987	Hi-Fi video which popularized the bar-code based advance setting system. Compatible with then stereo broadcasts.	
DVD Player	Dream	DVD-A100	1996	Our first ever DVD player. MPEG2 video decoder LSI provided high quality digital imaging.	
BD/DVD Recorder	DIGA	DMR-E700BD	2004	The world's first ever recorder to handle single-sided dual layer 50GB blu-ray disks. Our first ever blu-ray disk recorder.	

Unrestricted Lifestyles

Product name	Nickname	Model Number	Release year	Caption	Remarks
Ultra-slim Radio	Pepper	R-012	1977	The slimmest radio in the world at the time. At only 12.7 mm thick, three times thinner than a traditional device, it fitted in a shirt pocket.	
"Handy MacLord" Portable VHS Video Cassette Recorder		NV-3000	1980	The first ever portable VTR capable of six hours' recording. At the time, this was the smallest, lightest device, with the lowest energy consumption and the lowest price.	
Miniature 6-transistor Radio		T-10	1959	The world's smallest radio at the time. With features such as a ceramic variable condenser and flat speakers, the product used the latest miniature components.	
VHS Integrated Video Camera		NV-M1	1985	Japan's first VHS integrated video camera.	
"Digital mova P201HYPER" 800MHz Digital Mobile Phon			1996	At the time, it was the smallest and lightest digital mobile phone in the world that cut 100g for the first time as a digital system.	
"CDer" Portable CD Player		SL-XP5	1987	The newly developed double-sided aspheric cast glass enabled us to achieve a device which was only 2.29cm thick.	
"Blenby" Single Hand VHS-C Movie		NV-S1	1990	The world's first single-hand video camera with 'fuzzy gyro' image stabilizing technology.	
"AITE" Card Shaver		ES513	1990	A portable shaver, as small as a business card, and just 12mm thick.	
"Wa no Spinner W.D." Pocket Shaver		ES552	1983	A portable revolving shaver. The world's first when it went on sale in 1980. Carries on the legacy of the ES566 waterproof shaver.	
"Pocket Doltz" Sonic Vibrating Toothbrush		EW-DS11	2010	A compact electric toothbrush that can fit in your cosmetics bag. Popular for use after a lunch out.	
"Usudora" Hair Dryer		EH625	1980	A 20mm thin travel hair dryer.	
Compact Cassette Tape Recorder		RQ-210	1968	Ultra-compact tape recorder. Marketed under the name "Cassette IC", it became commercially popular and raised the company's technological reputation.	
"LUMIX" Interchangeable Lens (Mirrorless) Digital Single Lens Reflex Camera		DMC-G1	2008	The then world's smallest and lightest digital camera with interchangeable lenses and a movable liquid crystal screen. This is thanks to the world's first 'mirrorless' structure.	
Digital Camera		DMC-FX5	2003	The world's first compact digital camera with built-in image stabilizer and 3x optical zoom.	

*Exhibits are subject to change.

Providing a Sense of Security

Product name	Nickname	Model Number	Release year	Caption	Remarks
Bullet-shaped Battery-powered Bicycle Lamp			1923	A battery-powered bicycle lamp that took the place of then-mainstream candle and kerosene lamps. The product went on to gain popularity for staying lit approximately ten times longer than previous battery-powered lamps.	
Rugged Notebook PC	Toughbook (PRONOTE FG)	CF-25	1996	Work-site specialized laptop PC with improved shock- and drip-proof provided by special absorbing gel.	
3-band Portable Radio	COUGAR	RF-888	1973	Fitted with 16 cm speakers, the largest at the time in a portable device. Combined a unique design with high fidelity sound.	
2-band Portable Radio	MARINE NO.1	RF-622	1974	Japan's first ever horizontal floating waterproof portable radio. An extremely versatile 'amphibious' device suitable for a wide range of scenarios including leisure activities at sea or in the mountains, and even for use during disasters.	
Tape Recorder	Osharena Tereco U4	MR-U4	1979	A popular series of tape recorders. The name of the series and the long, compact design were a hit with the youth.	SANYO
Tape Recorder	Osharena Tereco WU4	MR-WU4	1979	A popular series of tape recorders. The double tape deck allowed for dubbing of audio material.	SANYO
Headphone Stereo	Shockwave	RQ-SW20	1996	Our first ever headphone stereo for the North American market. The toughness and waterproofing achieved by the rubber protection made it ideal for outdoor use.	
Rechargeable Screw Driver	EZ500		1979	Panasonic's first rechargeable tool. Formed the basis for the successor rechargeable drill, the EZ505, which also went on sale that year. The EZ505 had superior mass balance and was well rated by consumers.	
Ventilation Fan Designated for Public Housings			1958	Contributed to the development of the industry by allowing other companies access to industrial property rights and participating in joint experiments with public housing corporations.	
Residential Rain Gutters	Iron		1981	Quality gutters with a core of durable steel surrounded by rust-proof, durable plastics, molded as a single unit	
Light Bulb	"Panaball"		1970	Our lightbulb range,with five different sizes. They were widely used for mood lighting and decorative lighting in homes, hops, hotels and others.	
"Palook" Fluorescent Lamp			1977	Japan's first high-efficiency /high color-rendering fluorescent light. We aimed to make the light as natural looking as possible	
LED Ceiling Light for Homes		HH-LC700A	2011	The company's first low-energy, long-life LED ceiling light for homes. Equipped with long-life and ECONAVI functionality, this light source made low-energy lighting a reality.	
LED Ceiling Light for Shops and Buildings		NNN20605	2006	An advanced, comfortable, high-quality ceiling light for use as main lighting with the long-life and low-energy power of LED.	
"Spiral Palook Ceiling Light" for Home Use			2010	Our unique'flat surface spiral processing'fluorescent light. Helped save energy.	
Dry Cell Battery			1931	The company's first dry cell batteries used paper casing, and were mainly used in lamps.	
"Hyper" Dry Cell Battery			1954	The world's first full-metal-jacket dry battery. Compared to previous paper types, the new batteries could be stored for longer and lasted longer.	
High Performance Manganese Dry Cell Battery	Hi-Top		1963	The most powerful dry cell batteries in the world at the time. Electrolytic manganese dioxide gave them twice the lifetime of conventional batteries and enabled them to be stored for up to three years.	
High Performance Manganese Dry Cell Battery	NEO Hi-Top		1969	Research into a battery with capacity three times that of Hyper and 1.5 times that of Hi-Top began immediately. the NEO Hi-Top it boasted the world's longest battery life.	
Mercury-free Alkaline Battery			1992	The company's first mercury-free alkaline battery. Highly evaluated as a clean energy that No use of Mercury which is one of essential materials for dry battery.	
Alkaline Battery	"Evolta"		2008	At the time the alkaline dry cell battery with the world's longest life that was certified by GUINNESS world Record. Power protection for up to ten years, the longest in Japan.	

Putting Thought into Lifestyles

Product name	Nickname	Model Number	Release year	Caption	Remarks
Round-top Electric Kotatsu Heater			1930	Japan's first electric kotatsu heater with an adjustable thermostat. With a design that ensured the surroundings would not be damaged, the heater was a pioneer of UD products. The product's price was approximately half that of competitors.	
Rechargeable Batteries	eneloop eneloop universe		2005	The "eneloop" nickel-metal hydride rechargeable batteries kickstarted the development of "eneloop universe" products which facilitated a lifestyle in which products could be used over and over again.	SANYO
Amorphous Solar Battery Calculator		CX-1	1980	The world's first calculator with built-in amorphous solar battery. The first in a line of solar-powered battery products.	SANYO
Photovoltaic Module	HIT		1997	The company's very own photovoltaic module with an amorphous (non-crystalline) and monocrystal structure. Achieved the world's highest power conversion efficiency	SANYO
"Energy Creation-storage Linked System" for Home Use			2012	Complete management of power needs, from creation and storage, to practical use. Combines everyday safety needs with emergency readiness for a superior home energy management system.	Panel
Natural Refrigerant Heat Pump Water Heater	Eco Cute		2003	The company's first Eco Cute device. Instead of using CFCs, the device used carbon dioxide as a refrigerant.	Panel
Home Fuel Cell Co-Generation System	Ene-Farm		2009	The company's first Ene-Farm device. Developed predominantly for homes aiming to save electricity.	Panel
ETC On-board Device (Separate Antenna-type)		CY-ET100D	2001	The company's first ETC on-board device. The automatic fee-collecting function eliminated the need to stop at toll points, thereby controlling traffic and reducing the amount of exhaust gas (CO ₂) released into the atmosphere.	
Commercial Car Navigation System (Floor-type)		CN-V1000D	1993	The company's first commercial car navigation system. With self positioning using a fibre optic gyroscope, the system was the first in the industry to include an automatic route-finding function.	
Portable Car Navigation	Gorilla	NV-P1	1995	Japan's first portable car navigation system with built-in antenna. The product was developed so that the user could take the navigation system out of the car with them.	SANYO
Flashlight	Hikaru Chime	EC170 / EC170P	2009	A device used to notify of guests arrival through sound and light. Used by those hard of hearing and in places where there is difficulty in hearing sound.	
Pocket-Type Hearing Aid		CB-801	1959	The company's first hearing aid. Transistors were used to make them smaller, and mercury dry batteries to give them a long life.	
Behind-the-Ear Type Hearing Aid		WH-452	1974	The company's first behind-the-ear type hearing aid for the severely hard of hearing. High-output, coupled with its small size, made it perfect for a wide range of users.	
Voice-activated VHS Remote Controller		NV-FS850	1991	A voice-activated remote controller for recording videos. At the time, recording vidoes was a confusing process, and this controller enabled simple input of channel, day, and time by voice.	
Voice-activated TV Remote Controller		TH-36DH200	2001	A voice-activated remote controller for televisions. Eliminated need to search through digital TV guides and enabled channel selection simply by saying the genre or other requirements into the controller.	
Simple TV Remote Controller		TY-RM200	2004	A TV remote controller with only the most commonly used buttons. Simplified switching between analog and digital broadcasting when digital broadcasting was implemented.	
Voice-activated Air Conditioner Remote Controller		CZ-RR5	2003	A universal design air conditioner remote controller supporting units made by other companies. A temperature read aloud function and shape of the buttons allowed simple operation for a wide range of people.	
Color Television with Infrared Remote Controller		TH-6600FR	1972	The world's first color television with an infra-red remote control able to switch the set on and off, change channels and adjust sound volume.	
Full Color Wiring Device	Wide-Touch Switch		1974	Wiring devices with handles on all surfaces for improved usability.	
Wiring Device	Cosmo Series		1982	The much more usable, large handles were made more broadly available for wiring devices.	
Embedded Magnetic Power Outlet		WTF13404WK	2001	A magnetic outlet. Easily disconnects plugs if you trip. Inserting and removing plugs is also easy.	
Magnetic Power Outlet Tap Set		WH6601WP	2009	Magnetic tap that eliminates the need for electrical work. Enables you to insert and remove plugs into and from outlets with roughly 1/8 the needed force.	
Cordless Steam Iron	Karuru	NI-WL600	2010	The first symmetrical dual tipped 'double-head base'iron in Japan. Multi-directional movement shortened ironing time.	
Vacuum Cleaner	J Concept	MC-JP500G	2014	The first vacuum cleaner in the J Concept series. Reduced strain on user with the then world's lightest body and a large handle for easy cleaning while holding the vacuum.	

*Exhibits are subject to change.